

**Detail antistatic device**

Spring 6 (Acc. / Drawing: 5115/20)

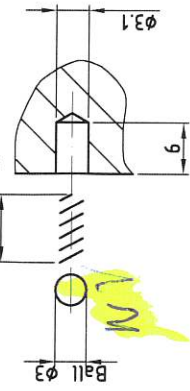

**Detail A**

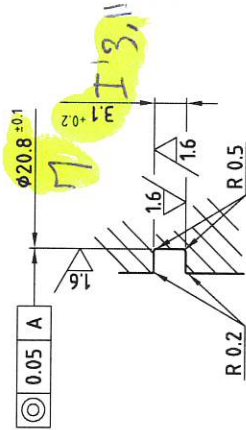

**Detail B**

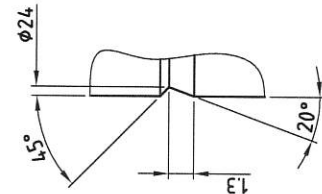

**Detail C**

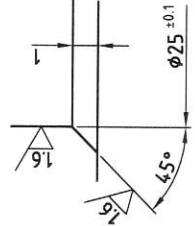

DIN 7168 Part 1 General tolerances in length & angular measures

Nominal measures	precision degree		
	max	min	tol
0.5	±0.1	±0.05	±0.02
1	±0.15	±0.07	±0.04
2	±0.2	±0.1	±0.05
3	±0.3	±0.15	±0.08
4	±0.4	±0.2	±0.1
5	±0.5	±0.25	±0.12
6	±0.6	±0.3	±0.15
7	±0.8	±0.4	±0.2
8	±1.0	±0.5	±0.25
9	±1.2	±0.6	±0.3
10	±1.5	±0.75	±0.35
11	±2.0	±1.0	±0.45
12	±2.5	±1.25	±0.55
13	±3.0	±1.5	±0.65
14	±4.0	±2.0	±0.85
15	±5.0	±2.5	±1.1
16	±6.0	±3.0	±1.3
17	±8.0	±4.0	±1.7
18	±10.0	±5.0	±2.2

DIN 7168 Part 2 General tolerances of shape

Nominal measures	precision degree		
	max	min	tol
0.5	±0.01	±0.005	±0.002
1	±0.015	±0.007	±0.003
2	±0.02	±0.01	±0.004
3	±0.03	±0.015	±0.006
4	±0.04	±0.02	±0.008
5	±0.05	±0.025	±0.01
6	±0.06	±0.03	±0.012
7	±0.08	±0.04	±0.015
8	±0.1	±0.05	±0.018
9	±0.12	±0.06	±0.02
10	±0.15	±0.075	±0.025
11	±0.2	±0.1	±0.03
12	±0.25	±0.125	±0.035
13	±0.3	±0.15	±0.04
14	±0.4	±0.2	±0.05
15	±0.5	±0.25	±0.06
16	±0.6	±0.3	±0.07
17	±0.8	±0.4	±0.09
18	±1.0	±0.5	±0.11
19	±1.2	±0.6	±0.13
20	±1.5	±0.75	±0.16
21	±2.0	±1.0	±0.2
22	±2.5	±1.25	±0.25
23	±3.0	±1.5	±0.3
24	±4.0	±2.0	±0.4
25	±5.0	±2.5	±0.5
26	±6.0	±3.0	±0.6
27	±8.0	±4.0	±0.8
28	±10.0	±5.0	±1.0

DIN 7168 Part 2

Nominal measures	precision degree		
	max	min	tol
0.5	±0.005	±0.002	±0.001
1	±0.007	±0.003	±0.0015
2	±0.01	±0.004	±0.002
3	±0.015	±0.006	±0.003
4	±0.02	±0.008	±0.004
5	±0.025	±0.01	±0.005
6	±0.03	±0.012	±0.006
7	±0.04	±0.015	±0.008
8	±0.05	±0.02	±0.01
9	±0.06	±0.025	±0.012
10	±0.08	±0.03	±0.015
11	±0.1	±0.04	±0.018
12	±0.12	±0.05	±0.02
13	±0.15	±0.06	±0.025
14	±0.2	±0.08	±0.03
15	±0.25	±0.1	±0.04
16	±0.3	±0.12	±0.05
17	±0.4	±0.15	±0.06
18	±0.5	±0.2	±0.08
19	±0.6	±0.25	±0.1
20	±0.8	±0.3	±0.13
21	±1.0	±0.4	±0.16
22	±1.2	±0.5	±0.2
23	±1.5	±0.6	±0.25
24	±2.0	±0.8	±0.35
25	±2.5	±1.0	±0.45
26	±3.0	±1.2	±0.55
27	±4.0	±1.6	±0.75
28	±5.0	±2.0	±1.0
29	±6.0	±2.4	±1.2
30	±8.0	±3.2	±1.6
31	±10.0	±4.0	±2.0

**"O" Ring**

Dimensions:  $\phi 20.29 \times 2.62$   
Material: Acc. to order

**Stem Thrust Seal**

Dimensions:  $\phi 32.7 \times \phi 25 \times 2.5$   
Material: Acc. to order

**HT-65 Stem Thrust Seal**

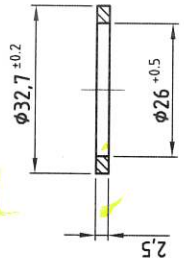

Material: AISI-316 + HT-65

Sharps edges to be removed

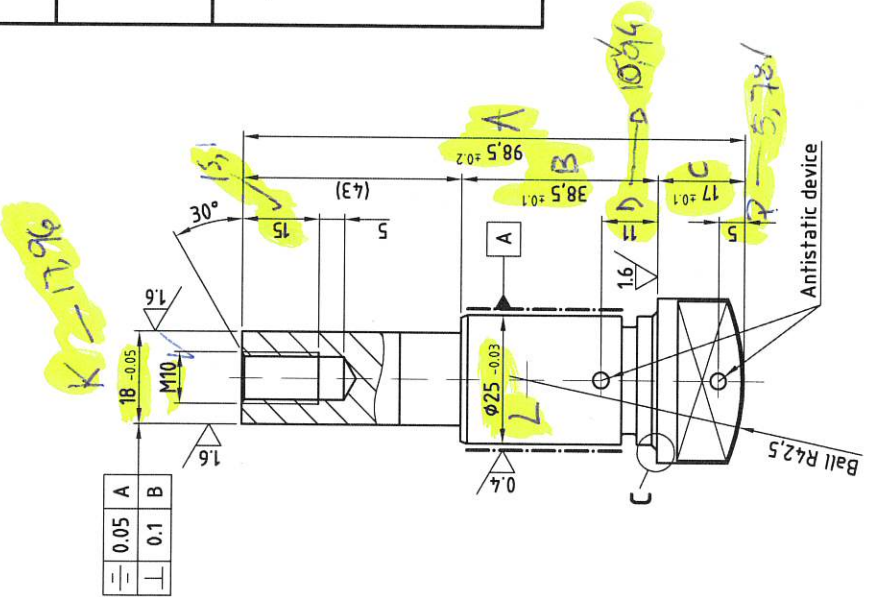

0.05	A	B
0.1	A	B
1.6	A	B

0.05	A	B
0.05	A	B
0.3	A	B

0.05	A	B
0.05	A	B
0.3	A	B

Scale:	1:1	Weight:	Pos.: 4
Material:	Your order	Pattern nr.:	
(Admin. diff. with sizes without tolerances)	DIN 7168 Rough	(Surface)	
Drawn:	03-11-14	Name	STEM
Chec.:	03-11-14	J. Rubio	FIG.560 DN-50
Norm.:	J.R.		"O" RING - STEM THRUST SEAL
Rev.:	01-14	J.R.	Sheet
Modification	Date	Name	E56050TJ
0	01-14	J.R.	Subs. by:
1			
2			
3			
4			
5			
6			
7			
8			
9			
10			
11			
12			
13			
14			
15			
16			
17			
18			
19			
20			
21			
22			
23			
24			
25			
26			
27			
28			
29			
30			
31			
32			
33			
34			
35			
36			
37			
38			
39			
40			
41			
42			
43			
44			
45			
46			
47			
48			
49			
50			

This drawing is our property. It is strictly forbidden to use the drawing, to give it to third parties or to reproduce it totally or partially without our permission.