

DN 7188 Part 2		
General tolerances of position		
precision degree	1	2,5
symmetry		
geometricity		
pitch		

DN 7188 Part 2			General tolerances of shape		
precision degree	S	Nominal measure	Nominal measure		
			0,5	1	1,6
Alignment		0,5	0,1	0,2	0,3
Form		0,5	0,1	0,2	0,3
Surface		0,5	0,1	0,2	0,3

DN 7188 Part 1			General tolerances in length & angular measures		
precision degree	g	f	Nominal measures		
			0,5	1	1,6
Length			0,5	0,1	0,2
Angle			0,5	0,1	0,2

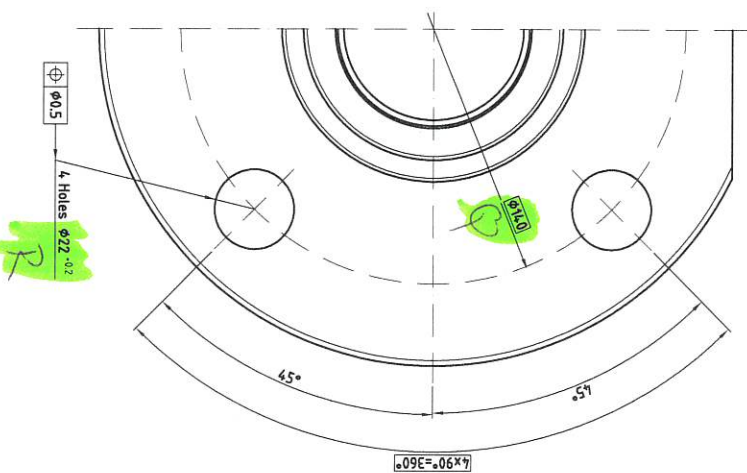
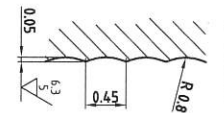
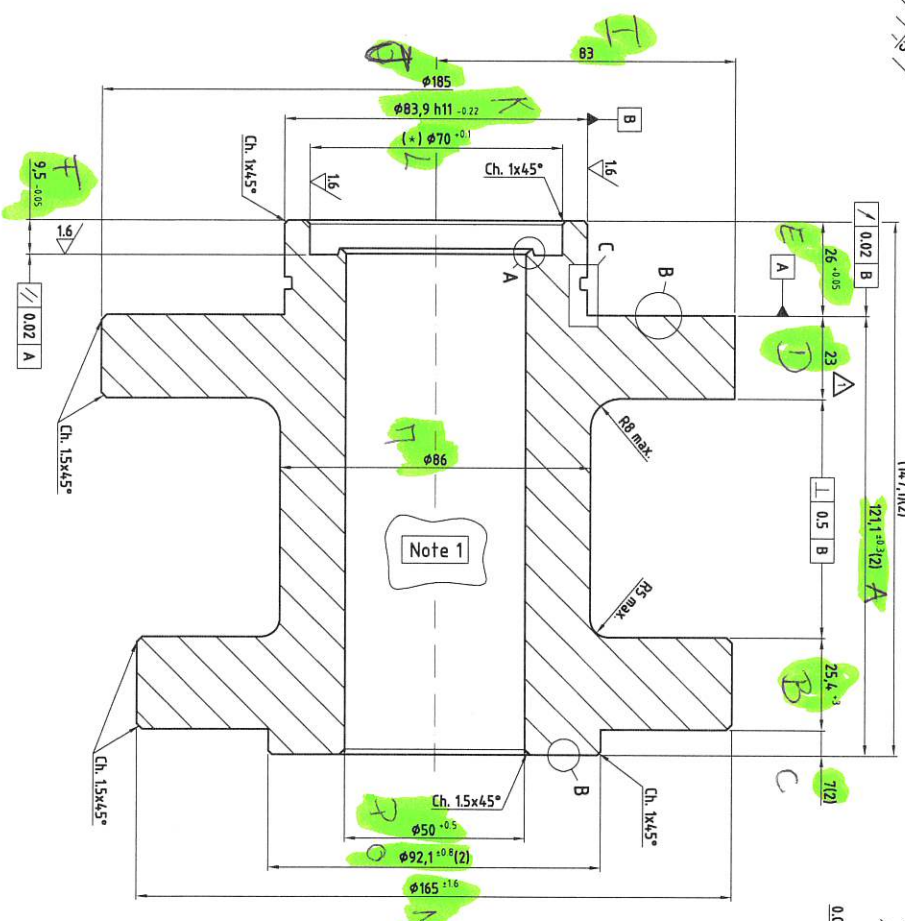
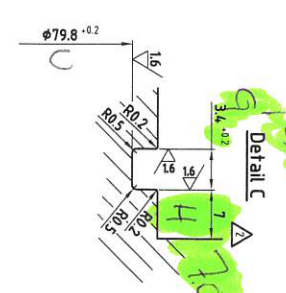
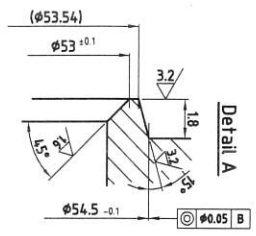
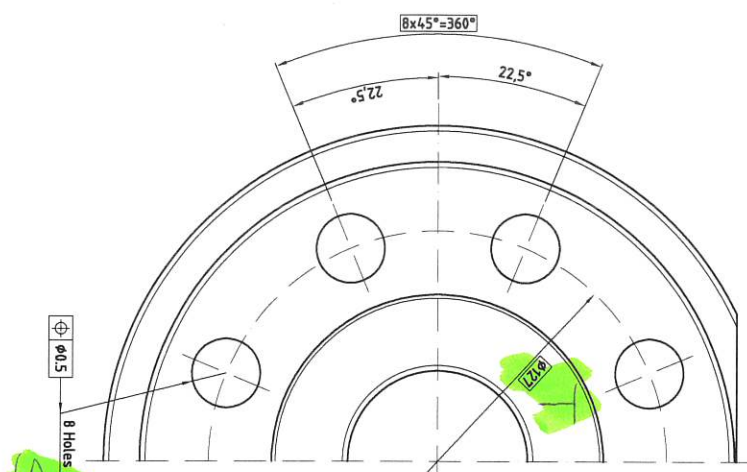

(2) When starting from R5 version, machine only this area

Note 1: Zone for stamp heat numbers and type of material
Sharp edges to be removed

(*) Tolerance: $\varnothing 0.05$ B

6.3 (1.6 / 5.3)

Rev.	Modification	Date	Name	Position	Signature
3	Modif. dimensions	10-12	J.C.	DR	
2	7 positions	4-10	J.R.	DR	
1	1st issue	7-98	C.C.	DR	
0	1st issue	4-96	J.R.	DR	

Product: 66 with head without dimensions	Material: Your order	Scale: 1:1	Weight: --- Kg	Pos.: 2
DN 7188 Rough	Pattern n°:			
Drawn: 11-4-96 J. RIBBO				
Check: 6-5-96 C.C.				
Nom:				

JC Valves		Drawing n°: L560B50	Sheet
FIG.560B DN-2" Class-600		Scale: 1:1	Weight: --- Kg
Date: 11-4-96		Pos.: 2	
Status: L560B50 Rev.2			